

GB PN Series

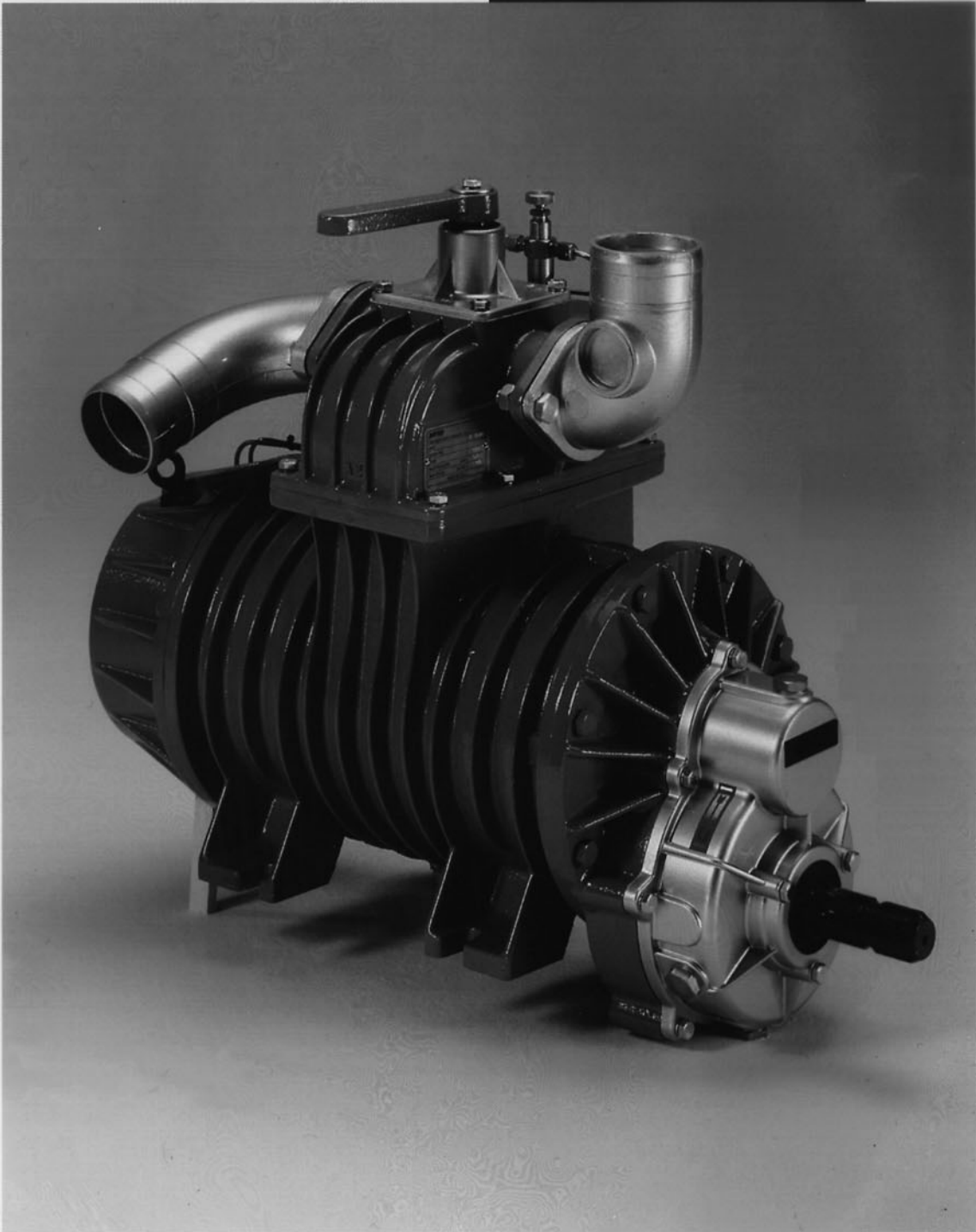

**Air cooled
vacuum pump**

Jurop
PORDENONE

Technical data / Overall dimensions mod. PN...D

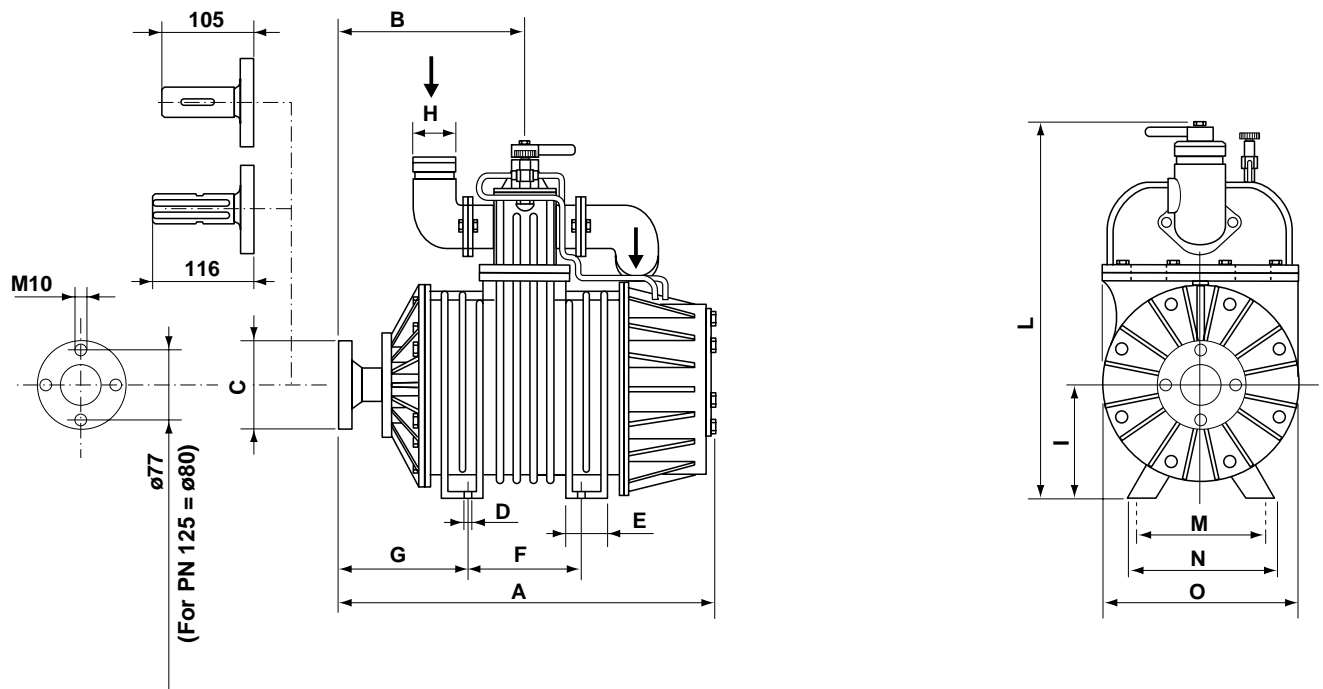

AIR COOLED VACUUM PUMPS-PN SERIES

Performances at 1300 R.P.M. - (max. speed)

Model		PN 23D	PN 33D	PN 45D	PN 58D	PN 84D	PN106D	PN 125D
Air flow - l./min.	Free air	2600	3600	5300	6500	9000	11000	13200
	60% vacuum	2100	2900	4500	5800	8100	10000	12000
Max vacuum - %		90	90	92	92	92	92	92
Max operating rel. pressure (abs.) - bar		0,5 (1,5)	0,5 (1,5)	0,5 (1,5)	0,5 (1,5)	0,5 (1,5)	0,5 (1,5)	0,5 (1,5)
Power required at 0,5 bar rel. (1,5 abs.) - kW		3,3	4,5	5,8	6,6	11,2	13,6	18,8
Weight - Kg.		53	63	90	102	115	143	190
Oil consumption g/h-drops/min total		65/40	80/45	90/50	90/50	115/65	135/80	150/95
Oil tank capacity - l.		1,2	1,2	2,3	2,3	2,3	2,3	4
Sound level at 60% vac. 7 m. dist. - dB (A) - with silencer		77	74	76	77	81	84	84

Dimensions in mm.

Model	A	B	C	D	E	F	G	H	I	L	M	N	O
PN 23D	466	276	98	16	60	92	226	60	135	408	170	195	215
PN 33D	546	306	98	16	60	160	226	60	135	415	170	195	215
PN 45D	426	206	98	16	50	140	131	60/76/80	150	508	240	270	275
PN 58D	486	226	98	16	80	190	136	60/76/80	175	538	240	270	275
PN 84D	586	276	98	16	80	190	186	60/76/80	150	518	240	270	275
PN 106D	676	321	98	16	70	290	181	60/76/80	175	538	250	285	290
PN 125D	650	300	102	16	95	300	150	100	210	590	275	320	320

The JUROP sliding vanes vacuum pumps, series PN, air cooled, are supplied complete with:

- Bakelite vanes.
- Forced lubrication.
- Vacuum/pressure change over valve, 4 ways.
- Non-return check valve.
- Aluminum inlet/outlet connections.
- Splined shaft, smooth shaft $\phi 35 \text{ mm}^{+0.13}_{-0.18}$ ($\phi 40 \text{ mm}$ for PN 125D) or with pulley.

Upon request:

- Special heat resistant vanes.
- "Mixer", change over valve with 5 ways.
- Electric, hydraulic or auxiliary engine drive.

Technical data / Overall dimensions mod. PN...M

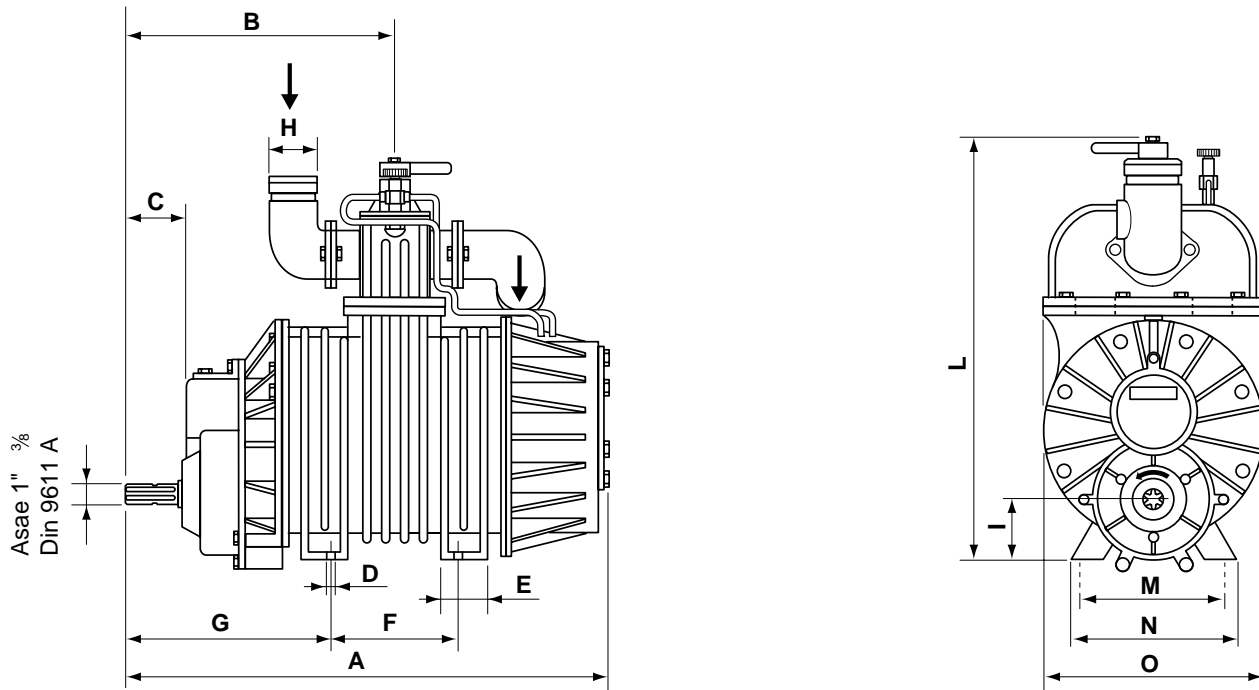

AIR COOLED VACUUM PUMPS-PN SERIES

Performances at 540 R.P.M. - (max. speed)

Model		PN 23M	PN 33M	PN 45M	PN 58M	PN 84M	PN106M	PN 125M
Air flow - l./min.	Free air	2600	3600	5300	6500	9000	11000	13200
	60% vacuum	2100	2900	4500	5800	8100	10000	12000
Max vacuum - %		90	90	92	92	92	92	92
Max operating rel. pressure (abs.) - bar		0,5 (1,5)	0,5 (1,5)	0,5 (1,5)	0,5 (1,5)	0,5 (1,5)	0,5 (1,5)	0,5 (1,5)
Power required at 0,5 bar rel. (1,5 abs.) - kW		3,3	4,5	5,8	6,6	11,2	13,6	18,8
Weight - Kg.		55	65	90	102	115	143	190
Oil consumption g/h-drops/min total		65/40	80/45	90/50	90/50	115/65	135/80	150/95
Oil tank capacity - l.		1,2	1,2	2,3	2,3	2,3	2,3	4
Sound level at 60% vac. 7 m. dist. - dB (A) - with silencer		77	74	76	77	81	84	84

Dimensions in mm.

Model	A	B	C	D	E	F	G	H	I	L	M	N	O
PN 23M	475	280	87	16	60	92	235	60	58	408	170	195	215
PN 33M	555	320	87	16	60	160	235	60	58	415	170	195	215
PN 45M	535	310	87	16	50	140	240	60/76/80	50	508	240	270	275
PN 58M	595	340	87	16	80	190	245	60/76/80	72	538	240	270	275
PN 84M	695	390	87	16	80	190	295	60/76/80	50	518	240	270	275
PN 106M	785	435	87	16	70	290	290	60/76/80	72	538	250	285	290
PN 125M	760	420	87	16	95	300	265	100	110	590	275	320	320

LIST OF RECOMMENDED OILS

Pump housing lubrication

Brand/Type	Environment temperature 5°±30° C ISO 46	Environment temperature > 40° C ISO 150
AGIP	Radula 46	Radula 150
ESSO	Nuray 46	Nuray 150
SHELL	Vitrea 46	Vitrea 150
ELF	Movixa 46	Movixa 150
MOBIL	Rubrex 300	Rubrex 900
BP	Engelol CS 46	Engelol CS 150

LIST OF RECOMMENDED OILS

Lubrication of gear box

Brand/Type	ISO 220
AGIP	Blasia 220
ESSO	Spartan EP 220
SHELL	Omala oil 220
ELF	Reductelf SP 220
MOBIL	Mobilgear 630
BP	Engelol GR XP 220

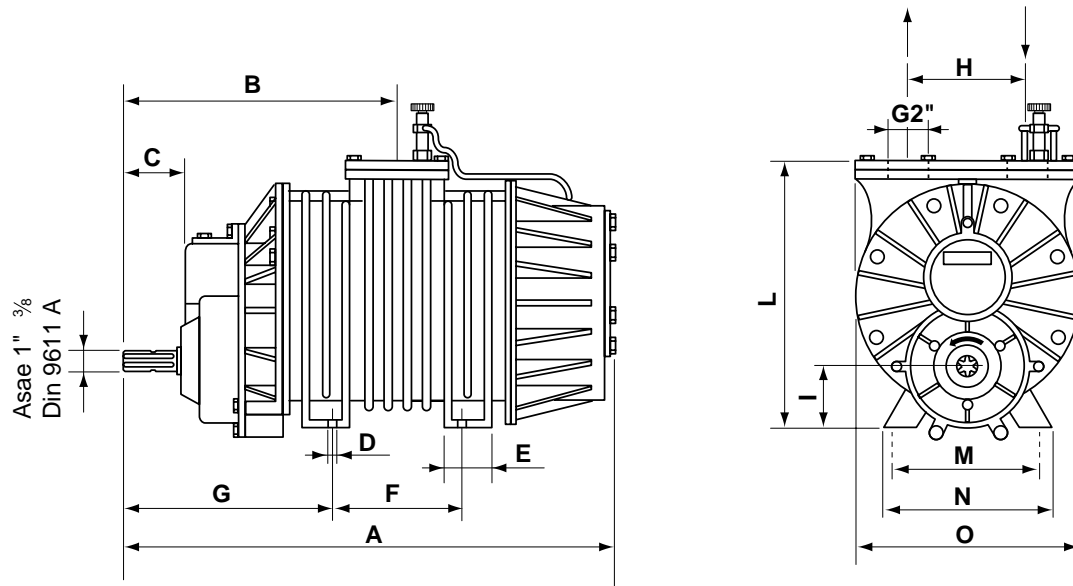

AIR COOLED VACUUM PUMPS-PN SERIES

Performances at 540 R.P.M. - (max. speed)

Mod.		PN 45FL	PN 58FL	PN 84FL	PN 106FL
Air flow - l./min.	Free air	5300	6500	9000	11000
	60% vacuum	4500	5800	8100	10000
Max vacuum - %		92	92	92	92
Max operating rel. pressure (abs.) - bar		3 (4)	3 (4)	3 (4)	3 (4)
Max operating rel. pressure for 5 min. (abs) - bar		1,5 (2,5)	1,5 (2,5)	1,5 (2,5)	1,5 (2,5)
Power at 1,5 bar absolute pressure - Kw		5,8	6,6	11,2	13,6
Weight - Kg.		84	95	108	136
Oil consumption g/h-drops/min total		90/50	90/50	115/65	135/80
Oil tank capacity - l.		2,3	2,3	2,3	2,3
Sound level at 60% vac. 7 m. dist. - dB (A) - with silencer		76	77	81	84

Dimensions in mm.

Mod.	A	B	C	D	E	F	G	H	I	L	M	N	O
PN 45FL	535	310	87	16	50	140	240	145	50	315	240	270	275
PN 58FL	595	340	87	16	80	190	245	145	72	345	240	270	275
PN 84FL	695	390	87	16	80	190	295	145	50	325	240	270	275
PN 106FL	785	435	87	16	70	290	290	145	72	345	250	285	290